

F. EXAMPLE PROJECTS WHICH BEST ILLUSTRATE PROPOSED TEAM'S QUALIFICATIONS FOR THIS CONTRACT <i>(Present as many projects as requested by the agency, or 10 projects, if not specified. Complete one section F for each project.)</i>		20. EXAMPLE PROJECT KEY NUMBER
21. TITLE AND LOCATION <i>(City and State)</i>		22. YEAR COMPLETED
Consumers Energy Alma Service Center – Major Systems Upgrade Jackson, MI		PROFESSIONAL SERVICES 2006 CONSTRUCTION <i>(If applicable)</i> 2007-2008

23. PROJECT OWNER'S INFORMATION

a. PROJECT OWNER Consumers Energy	b. POINT OF CONTACT Mike Smith	c. POINT OF CONTACT TELEPHONE NUMBER
--------------------------------------	-----------------------------------	--------------------------------------

24. BRIEF DESCRIPTION OF PROJECT AND RELEVANCE TO THIS CONTRACT <i>(Include scope, size and cost)</i>

SCOPE OF WORK

Elite was commissioned to provide the following services for the \$8,000,000 Major Systems Upgrade of the Consumers Energy Facility with an engineering and construction oversight fee of \$337,900:

- Engineering and design services
- Economic feasibility studies and cost estimates
- Preparation of contract documents and bid analysis
- Construction monitoring required for the replacement of designated major systems including:
 - HVAC – RTU w/DX system & VAV boxes
 - Plumbing, sanitary & water
 - Boiler upgrades
 - Power upgrades, distribution panel & wiring
 - Emergency Generator and UPS system
 - Interior lighting
 - Fire protection, alarm & security system
 - Major architectural & space plans
 - Site improvements, parking & storm drainage

RELEVANCE

Elite reviewed the current facility operation with respect to the client's needs. A detailed study was performed by each discipline. Elite designed new HVAC and Electrical systems for the facility and determined that some of the existing systems were able to be salvaged and integrated into the new design. Further, Elite coordinated the relocation and use of some existing equipment in this and other facilities.

Elite provided a complete set of drawings and specifications for this project.

This project was structured into three phases allowing the Owner to maintain operations within the facility throughout the construction period.

Elite will be providing construction oversight through construction in 2007-2008 and as-built drawings at the end of the project.

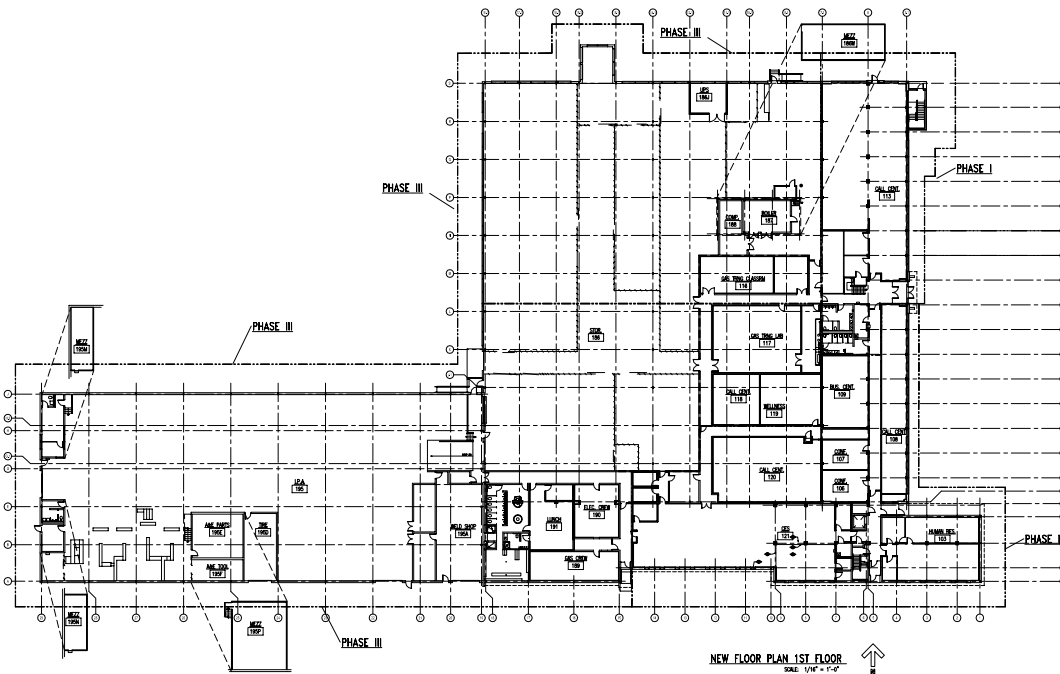

FLOOR PLAN

P-000140

25. FIRMS FROM SECTION C INVOLVED WITH THIS PROJECT			
a.	(1) FIRM NAME Elite Engineering Services, Inc.	(2) FIRM LOCATION <i>(City and State)</i> Jackson, Michigan	(3) ROLE Project Engineer